

EMERGENCY SNOW ROUTES

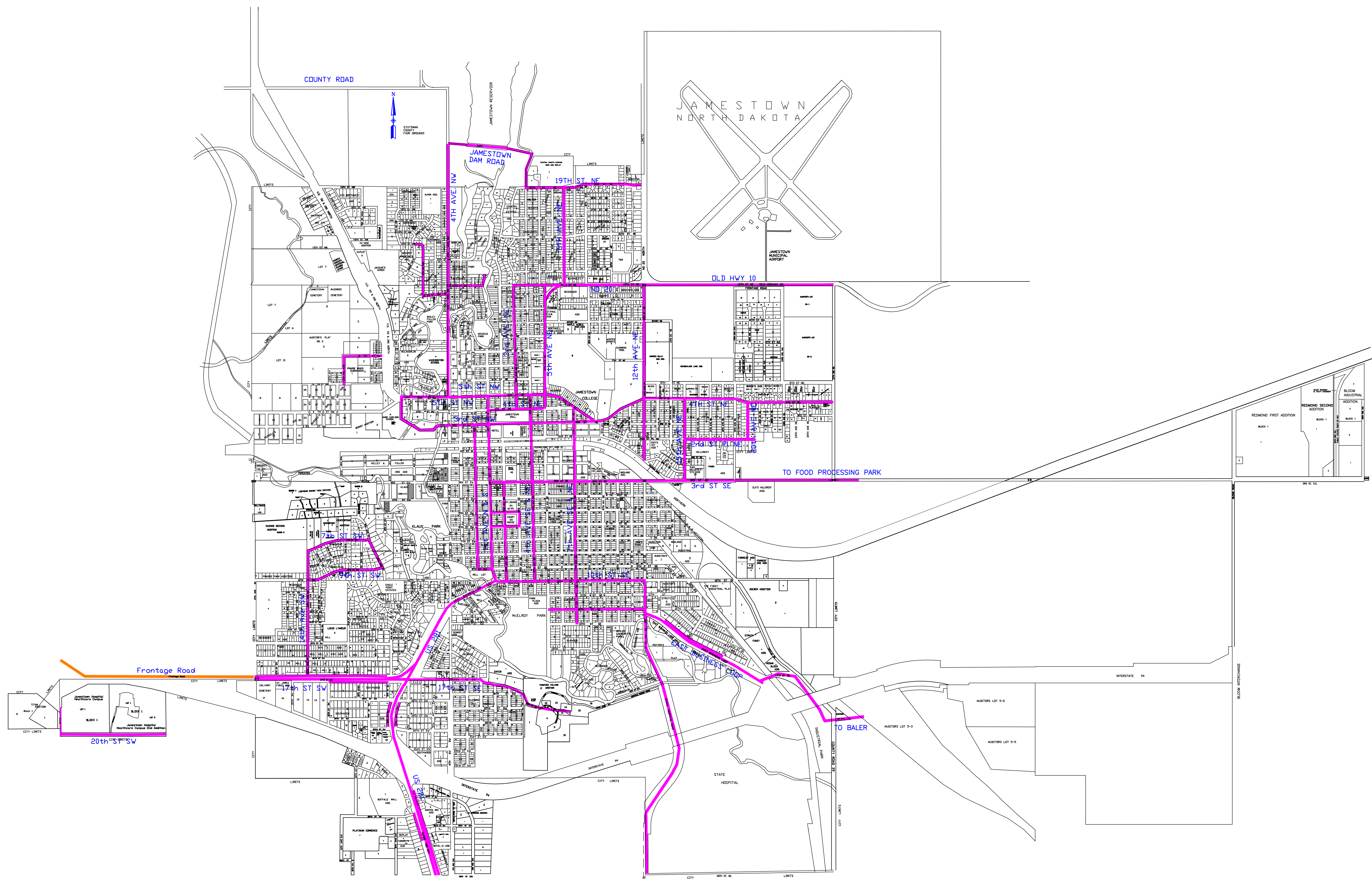

— SNOW EMERGENCY ROUTE
— ONLY UNDER EMERGENCY/BLIZZARD CONDITIONS

October 8, 2012

CITY OF JAMESTOWN
ENGINEERING DEPARTMENT

Emergency Snow Routes
SCALE: N.T.S.

DRAWN BY:
TJM
DATE:
1-24-14

SHEET
1-1